

SPRING-LOADED PINS

DISCRETE SPRING-LOADED CONTACTS • THROUGH-HOLE MOUNT

0906-0

0906-0-15-20-76-14-11-0

Short stroke

Solder mount in 0,51 min. mounting hole

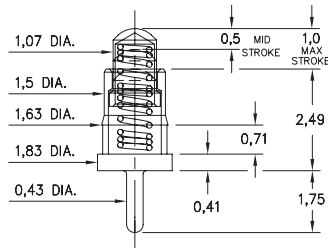

0906-1 ⇨ 4,8

0906-X-15-20-7X-14-11-0

Standard stroke

Solder mount in 0,51 min. mounting hole

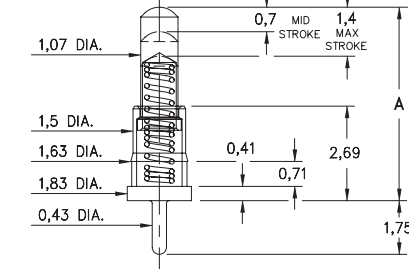

Basic Part Number	Length A
-------------------	----------

0906-1	4,5
0906-2	5,0
0906-3	5,51
0906-4	5,99
*0906-8	3,94

*0906-8 has a 0,5 Mid. Stroke & 1,0 Max. Stroke

0930

0930-0-15-20-75-14-11-0

Standard stroke

Solder mount in .051 min. mounting hole

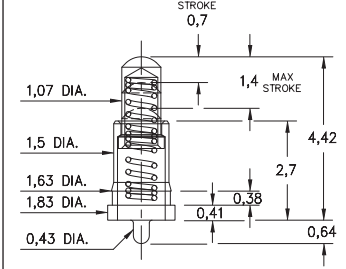

0914

0914-0-15-20-77-14-11-0

Long stroke

Solder mount in 0,74 min. mounting hole

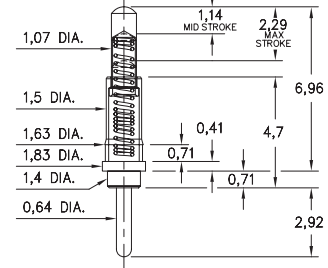

0908-0 ⇨ 9

0908-X-15-20-75-14-11-0

Standard stroke

Solder mount in 0,51 min. mounting hole

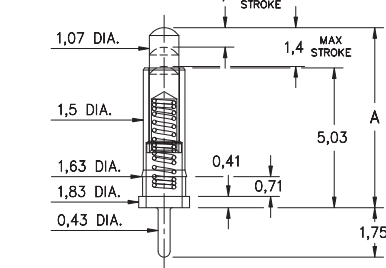

Basic Part Number	Length A
-------------------	----------

0908-0	6,48
0908-1	6,99
0908-2	7,49
0908-3	8,0
0908-4	8,51
0908-5	8,89
0908-6	9,4
0908-7	9,91
0908-8	10,41
0908-9	10,92

0932

0932-0-15-20-77-14-11-0

Long stroke

Solder mount in 0,74 min. mounting hole

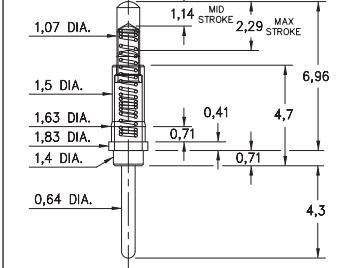

0901

0901-0-15-20-75-14-11-0

"Legacy P/N 0901-0-00-00-00-00-11-0"

Solder mount in 0,74 min. mounting hole

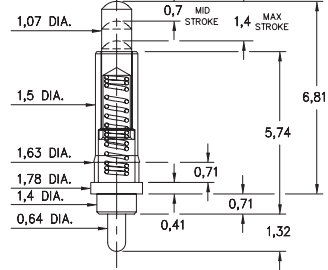

0929

0929-0-15-20-75-14-11-0

Standard stroke

Solder mount in 0,74 min. mounting hole

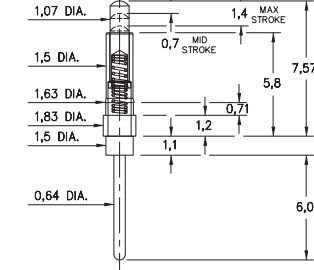

0922

0922-0-15-20-75-14-11-0

Standard stroke

Solder mount in 0,74 min. mounting hole

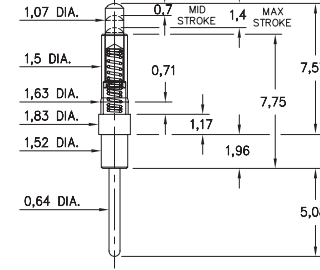

0956

0956-0-15-20-75-14-11-0

Standard stroke

Solder mount in 0,89 min. mounting hole

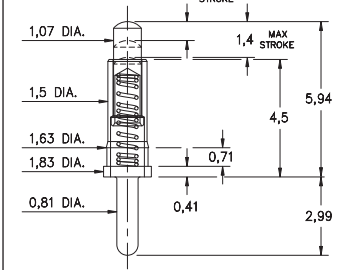

Material Specifications:

Sleeve & Plunger Material: Copper Alloy

Spring Material: Beryllium Copper

Sleeve & Plunger Finish: 0,5µm Gold over Nickel

Spring Finish: 0,25µm Gold over Nickel

Dimensions: Millimeters

Tolerances On: Lengths: ± 0,15

Diameters: ± 0,051

Angles: ± 2°



Mechanical & Electrical Specifications:

Durability: 1,000,000 cycles

Current Rating: 2A continuous, 3A peak

Contact Resistance: 20 mΩ max.

Environmental Specifications:

Operating temperature range: -55/+125°C

75, 76, 77 Springs are not interchangeable

Order Code: 09XX - X - 15 - 20 - 7X - 14 - 11 - 0

Spring Number ↑

Spring Number	Mid. Stroke	Max. Stroke	Force @ Mid. Stroke	Initial Force (Pre-Load)
75	0,7	1,4	60 g	25 g
76	0,5	0,99	60 g	25 g
77	1,14	2,29	60 g	25 g

